

51 Assemble the parts as shown here.

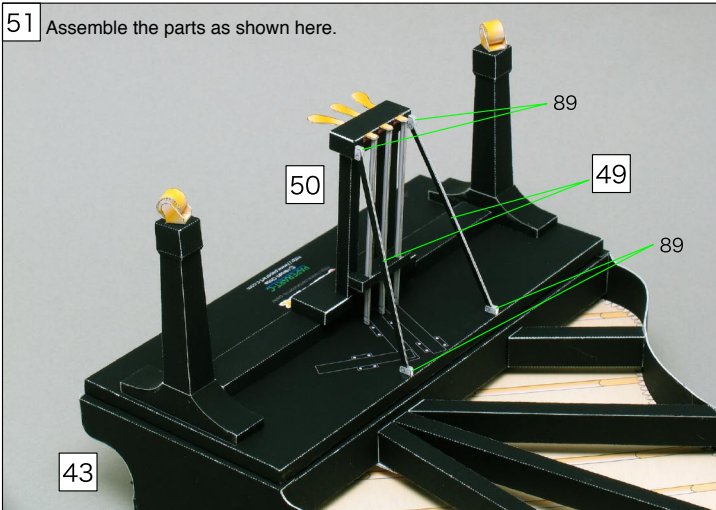

55 Assemble the parts as shown here.

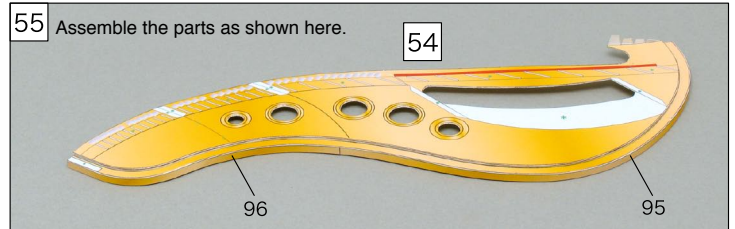

56

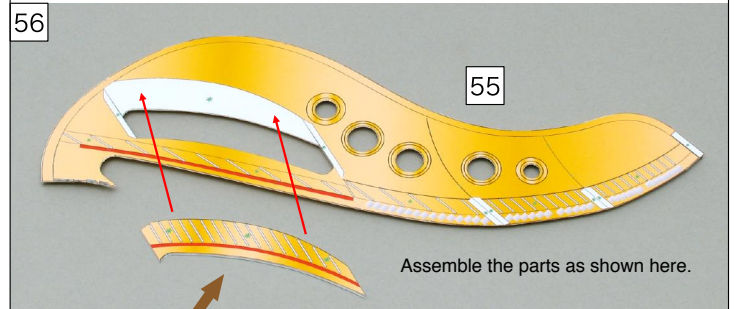

57

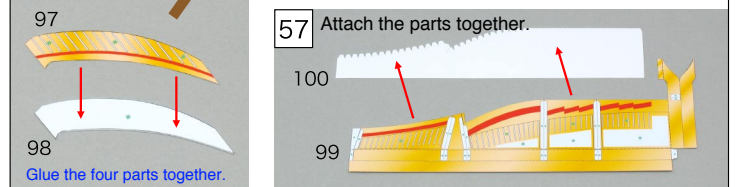

58

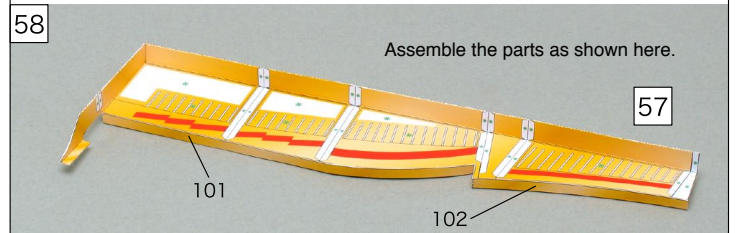

59

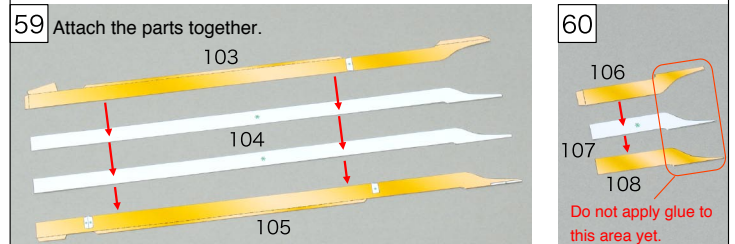

60

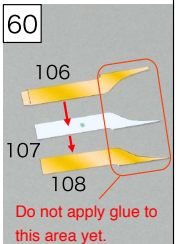

61

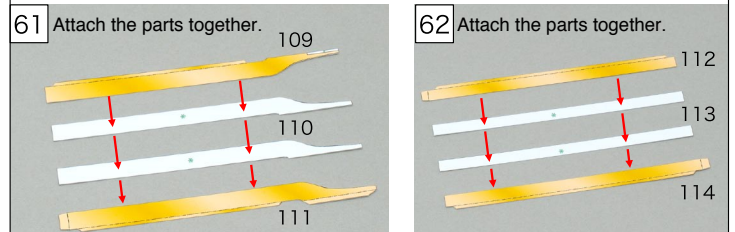

62

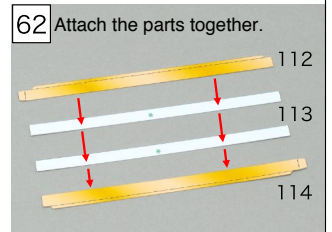

63

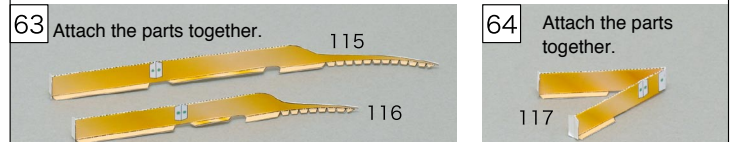

64



G Making the frame.

52

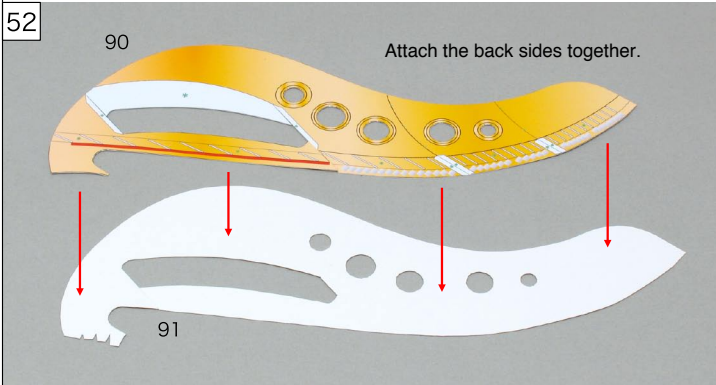

53

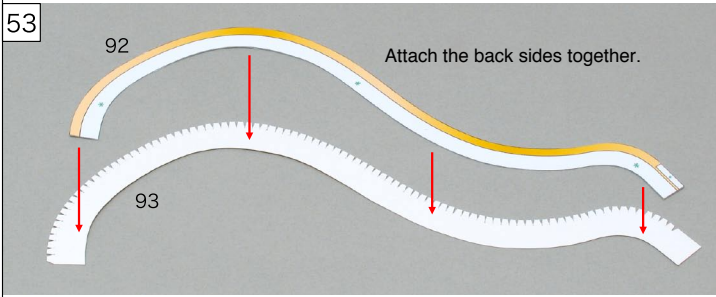

54

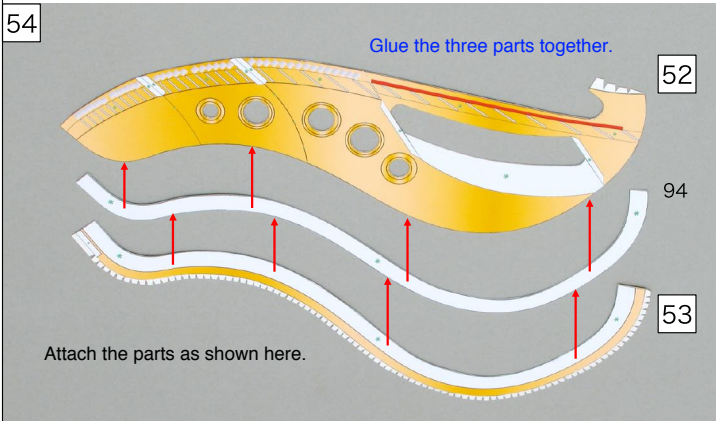

65 Assemble the parts as shown here.

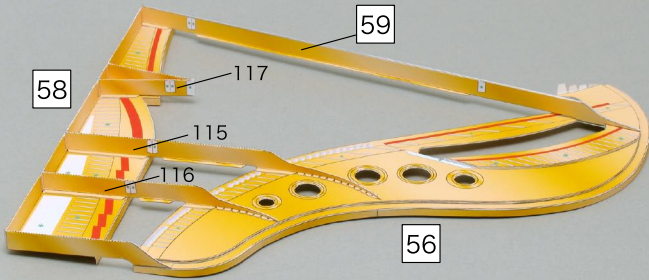

66 Assemble the parts as shown here.

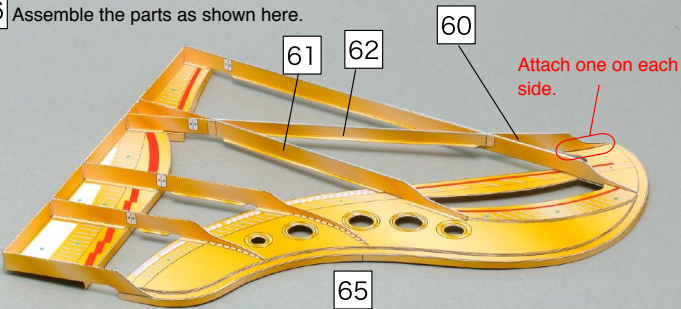

67 Assemble the parts as shown here.

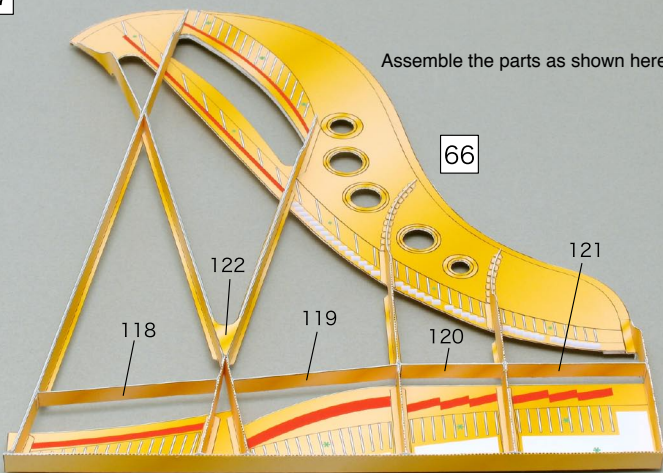

69

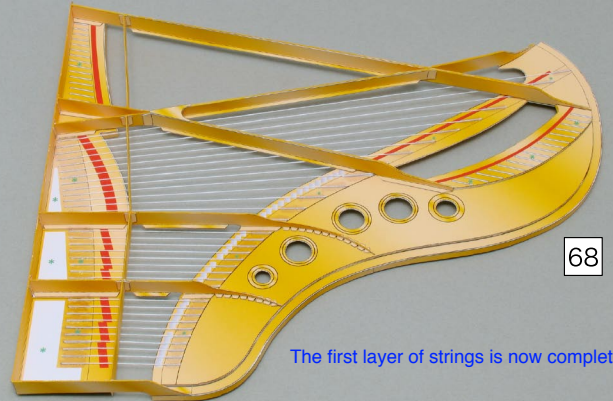

The first layer of strings is now complete.

70

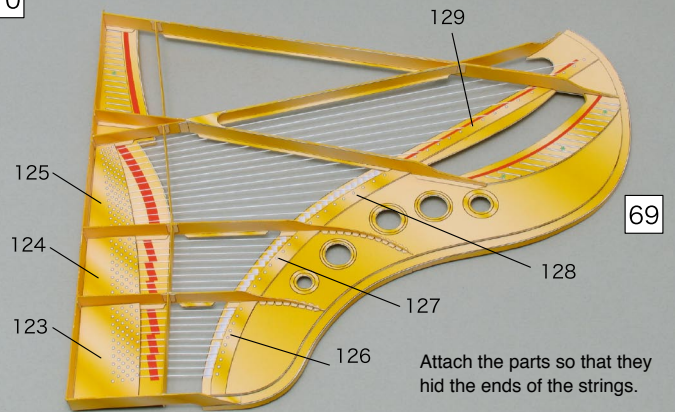

71

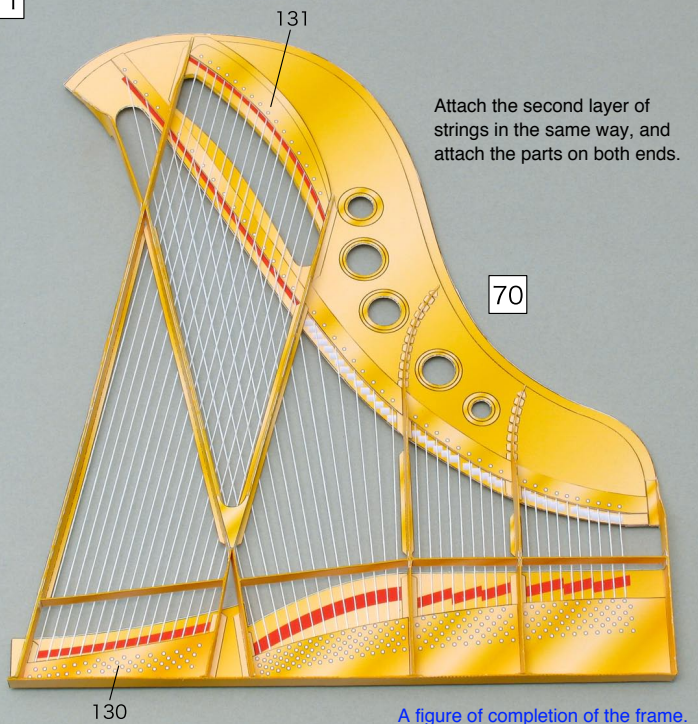

A figure of completion of the frame.

H Stringing the grand piano.

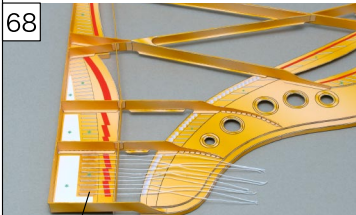

Use adhesive to secure the ends of the strings. Thread (size 20)



Secure the other ends of the strings with adhesive, too.

I Making the music desk.

72 Assemble the parts as shown here.



73 Attach the back sides together.

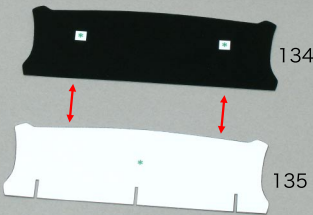

Attach 136 to the back side of made in 73.

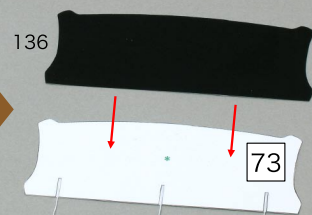

Attach the strings into the slots.

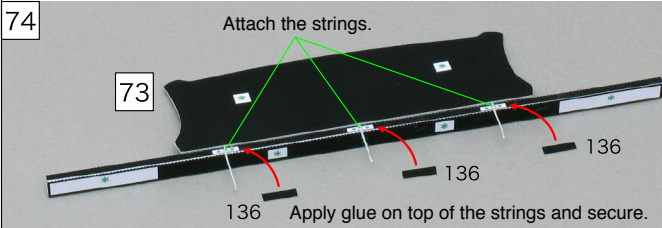

Cut off the leftover string.

75 Attach the back sides together. ①

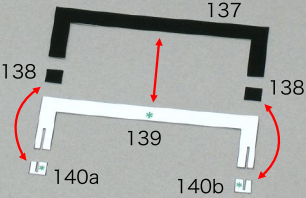

Attach the parts together. ③

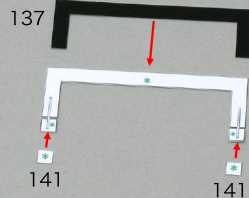

Attach the strings into the slots. ②



A figure of completion. ④



76 Assemble the parts as shown here.

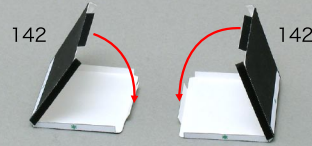

77 Attach the parts.

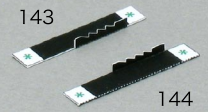

78

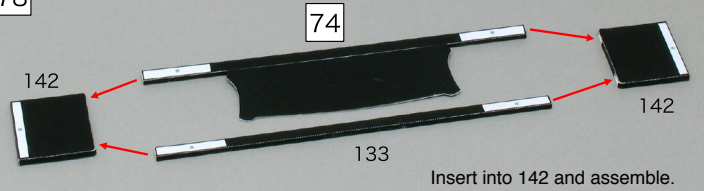

79 Assemble the parts as shown here.

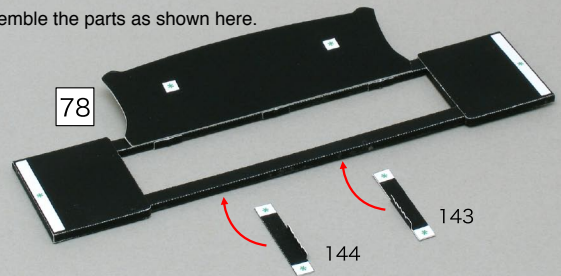

80 Assemble the parts as shown here.

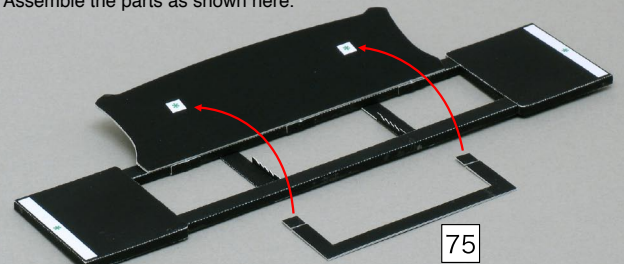

Use the supporter at the back to stand up the music desk.

81 Assemble the parts as shown here.



J Making the lid prop.

82 Assemble the parts as shown here.



A figure of completion.

K Making the lid.

83 Attach the parts together.

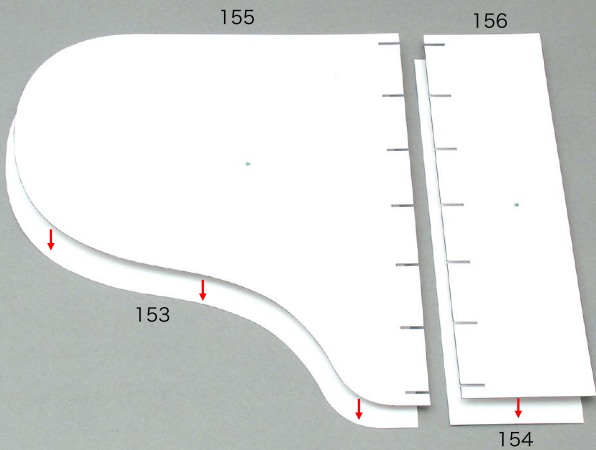

84

Attach the strings into the slots.

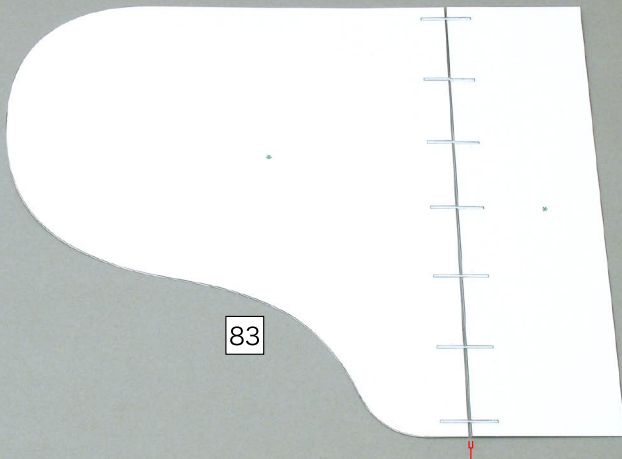

Leave a gap of about 1.5mm.

85 Attach the parts together.

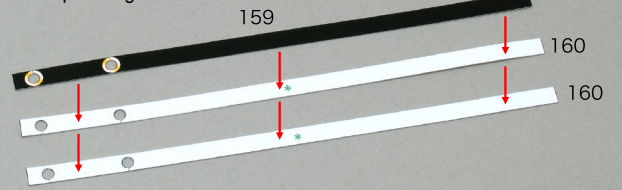

86

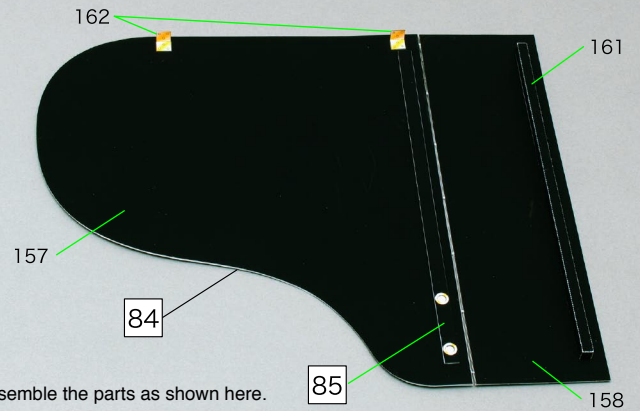

Assemble the parts as shown here.

L Attach each part to the body.

87 Assemble the parts as shown here.

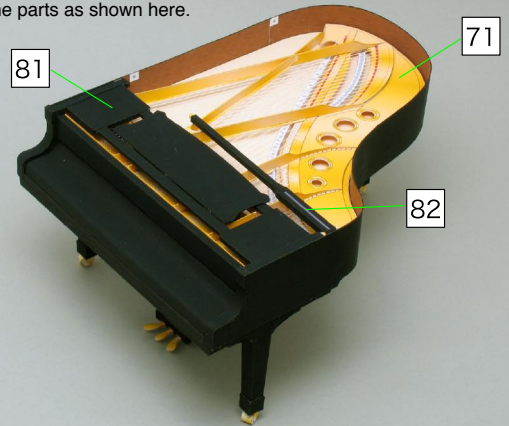

88 Glue the lid to the body, and your Grand piano is complete!

